

# DATA SHEET

## Three Phase Induction Motor - Squirrel Cage



Customer : MGE  
Customer reference : MGE

Product line : FLAMEPROOF W22Xdb

Product code : 15540466

Frame	: 71	Cooling method	: IC411 - TEFC
Insulation class	: F	Mounting	: B5T
Duty cycle	: S1	Rotation <sup>1</sup>	: Both (CW and CCW)
Ambient temperature	: -20°C to +40°C	Starting method	: Direct On Line
Altitude	: 1000 m.a.s.l.	Approx. weight <sup>3</sup>	: 22.4 kg
Protection degree	: IP56	Moment of inertia (J)	: 0.0008 kgm <sup>2</sup>
Design	: N		

Output [kW]	0.37	0.37	0.37	0.37
Poles	4	4	4	4
Frequency [Hz]	50	50	50	60
Rated voltage [V]	220/380	230/400	240/415	460
Rated current [A]	1.74/1.01	1.72/0.987	1.69/0.979	0.883
L. R. Amperes [A]	8.02/4.65	8.24/4.74	8.46/4.89	4.86
LRC [A]	4.6	4.8	5.0	5.5
No load current [A]	1.02/0.590	1.13/0.650	1.21/0.700	0.600
Rated speed [RPM]	1380	1395	1405	1710
Slip [%]	8.00	7.00	6.33	5.00
Rated torque [Nm]	2.56	2.53	2.52	2.07
Locked rotor torque [%]	270	300	330	360
Breakdown torque [%]	260	290	320	350
Service factor	1.00	1.00	1.00	1.00
Temperature rise	80 K	80 K	80 K	80 K
Locked rotor time	36s (cold) 20s (hot)	36s (cold) 20s (hot)	36s (cold) 20s (hot)	36s (cold) 20s (hot)
Noise level <sup>2</sup>	43.0 dB(A)	43.0 dB(A)	43.0 dB(A)	47.0 dB(A)
Efficiency (%)	25%			
	50%	73.0	73.0	70.0
	75%	75.0	75.0	75.0
	100%	77.3	77.3	78.5
Power Factor	25%			
	50%	0.53	0.50	0.47
	75%	0.64	0.62	0.58
	100%	0.72	0.70	0.67

Losses at normative operating points (speed;torque), in percentage of rated output power

Losses (%)	P1 (0,9;1,0)	28.7	28.7	28.7	26.8
	P2 (0,5;1,0)	26.1	26.1	26.1	24.3
	P3 (0,25;1,0)	25.0	25.0	25.0	23.3
	P4 (0,9;0,5)	14.8	14.8	14.8	13.8
	P5 (0,5;0,5)	10.9	10.9	10.9	10.1
	P6 (0,5;0,25)	7.8	7.8	7.8	7.3
	P7 (0,25;0,25)	5.8	5.8	5.8	5.4

	Drive end	Non drive end	Foundation loads
Bearing type	: 6202 ZZ	6202 ZZ	Max. traction : 148 N
Sealing	: Oil Seal	Lip Seal	Max. compression : 368 N
Lubrication interval	: -	-	
Lubricant amount	: -	-	
Lubricant type	: Mobil Polyrex EM		

This revision replaces and cancel the previous one, which must be eliminated.

- (1) Looking the motor from the shaft end.
- (2) Measured at 1m and with tolerance of +3dB(A).
- (3) Approximate weight subject to changes after manufacturing process.
- (4) At 100% of full load.

These are average values based on tests with sinusoidal power supply, subject to the tolerances stipulated in IEC 60034-1.

Rev.	Changes Summary	Performed	Checked	Date
Performed by				
Checked by				
Date	03/05/2023		Page 1 / 3	Revision

# DATA SHEET

## Three Phase Induction Motor - Squirrel Cage



Customer : MGE  
Customer reference : MGE

Notes

Rev.	Changes Summary		Performed	Checked	Date
Performed by			Page 2 / 3		Revision
Checked by					
Date	03/05/2023				

# DATA SHEET



## Three Phase Induction Motor - Squirrel Cage

Customer : MGE  
Customer reference : MGE

### Thermal protection

ID	Application	Type	Quantity	Sensing Temperature
1	Winding	Thermistor - 2 wires	1 x Phase	150 °C

### Space heater information

Voltage: 200 - 240 V

Rev.	Changes Summary		Performed	Checked	Date
Performed by				Page	Revision
Checked by				3 / 3	
Date	03/05/2023				

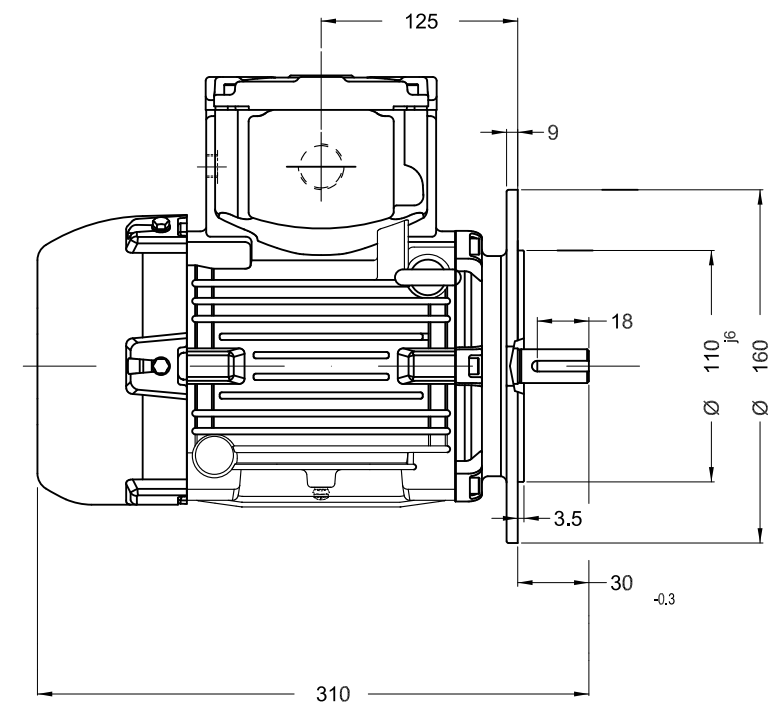

0.37 kW   04 Poles   50 Hz

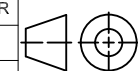

WEG's property. Forbidden reproduction without previous authorization.