

DATA SHEET



Three Phase Induction Motor - Squirrel Cage

Customer : MGE
Customer reference : MGE

Product line : W22Xdb IE3 Three-Phase Product code : 15546385

Frame	: 112M	Locked rotor time	: 21s (cold) 12s (hot)
Output	: 4 kW (5.5 HP)	Temperature rise	: 80 K
Poles	: 2	Duty cycle	: S1
Frequency	: 50 Hz	Ambient temperature	: -20°C to +40°C
Rated voltage	: 400/690 V	Altitude	: 1000 m.a.s.l.
Rated current	: 7.68/4.45 A	Protection degree	: IP56
L. R. Amperes	: 62.2/36.0 A	Cooling method	: IC411 - TEFC
LRC	: 8.1	Mounting	: B3T
No load current	: 3.30/1.91 A	Rotation ¹	: Both (CW and CCW)
Rated speed	: 2910 rpm	Starting method	: VFD
Slip	: 3.00 %	Approx. weight ³	: 73.0 kg
Rated torque	: 13.1 Nm		
Locked rotor torque	: 250 %		
Breakdown torque	: 340 %		
Insulation class	: F		
Service factor	: 1.00		
Moment of inertia (J)	: 0.0080 kgm ²		
Design	: N		

Output	25%	50%	75%	100%	Foundation loads	
Efficiency (%)	0.000	88.0	88.4	88.4	Max. traction	: 577 N
Power Factor	0.00	0.68	0.79	0.85	Max. compression	: 1293 N

Losses at normative operating points (speed;torque), in percentage of rated output power

P1 (0,9;1,0)	P2 (0,5;1,0)	P3 (0,25;1,0)	P4 (0,9;0,5)	P5 (0,5;0,5)	P6 (0,5;0,25)	P7 (0,25;0,25)
13.1	11.9	10.9	6.1	4.3	2.7	2.0

	Drive end	Non drive end
Bearing type	: 6207 ZZ	6206 ZZ
Sealing	: Oil Seal	Lip Seal
Lubrication interval	: 0 h	0 h
Lubricant amount	: 0 g	0 g
Lubricant type	: Mobil Polyrex EM	

Notes

This revision replaces and cancel the previous one, which must be eliminated.

- (1) Looking the motor from the shaft end.
- (2) Measured at 1m and with tolerance of +3dB(A).
- (3) Approximate weight subject to changes after manufacturing process.
- (4) At 100% of full load.

These are average values based on tests with sinusoidal power supply, subject to the tolerances stipulated in IEC 60034-1.

Rev.	Changes Summary	Performed	Checked	Date
Performed by				
Checked by			Page	Revision
Date	24/10/2023		1 / 2	

DATA SHEET



Three Phase Induction Motor - Squirrel Cage

Customer : MGE
Customer reference : MGE

Thermal protection

ID	Application	Type	Quantity	Sensing Temperature
1	Winding	Thermistor - 2 wires	1 x Phase	150 °C

Space heater information

Voltage: 200 - 240 V

Rev.	Changes Summary	Performed	Checked	Date
Performed by				
Checked by			Page	Revision
Date	24/10/2023		2 / 2	

1 2 3 4 5 6

A

B

C

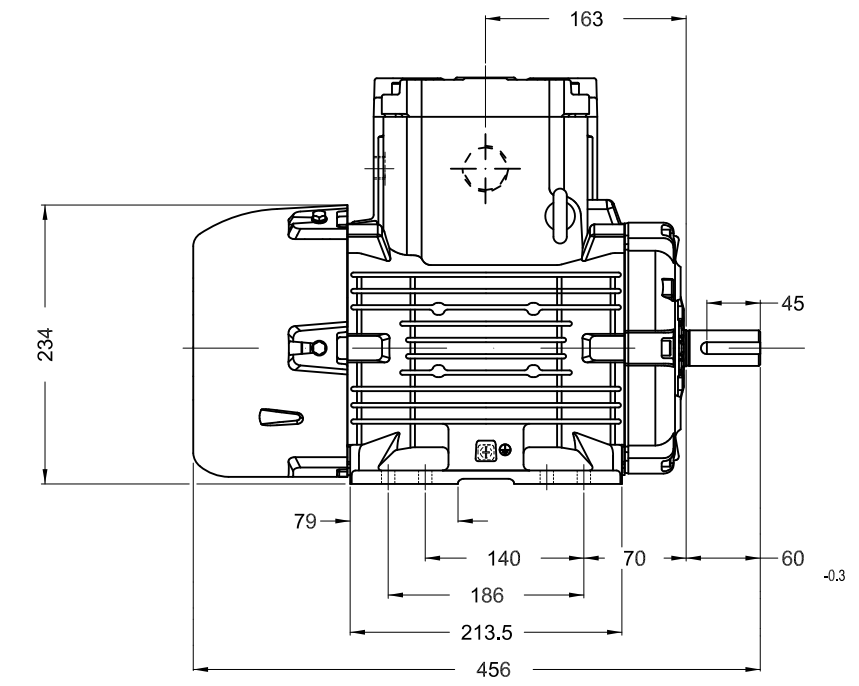
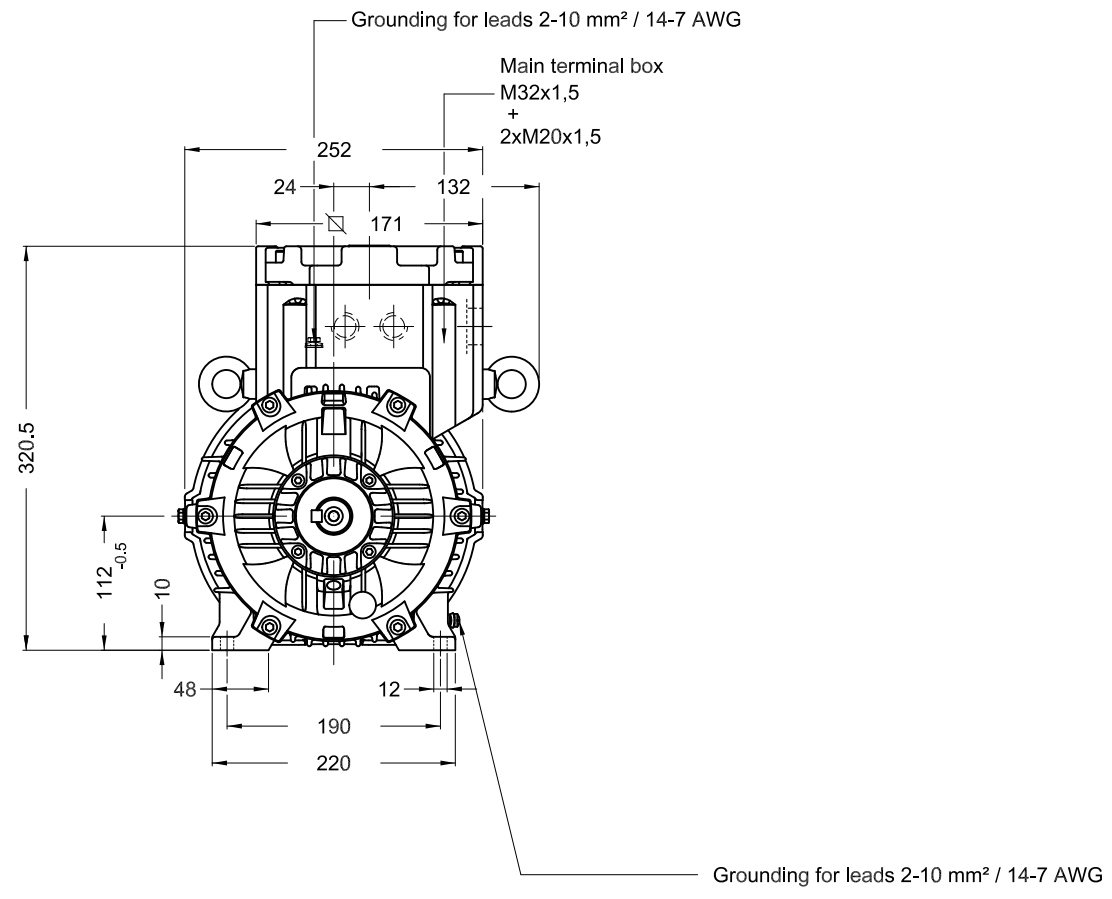

D

E

Ex eb Increased safety terminal block
 Color RAL 5009
 Painting plan 205P
 Mounting B3T

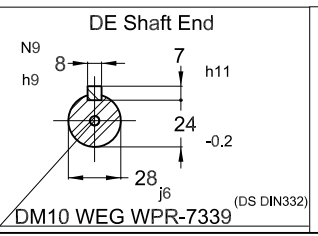

4 kW 02 Poles 50 Hz A

						HYBRISUSER								00	
ECM	LOC	SUMMARY OF MODIFICATIONS				EXECUTED	CHECKED	RELEASED	DATE	VER					
EXECUTED	HYBRISUSER	THREE PH. MOTOR W22Xdb IE3		FRAME 112M IP56 TEFC		PREVIEW		WDD 00		WEG					
CHECKED						SHEET		1 / 1							
RELEASED															
REL. DATE		WMO	Jaragua do Sul	Product Engineering											